

10GA STL PLATE

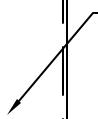

6" SQ X 1/4" W.
STL TUBE



36"

36"

42"

1/2" REBAR
(BY OTHER)

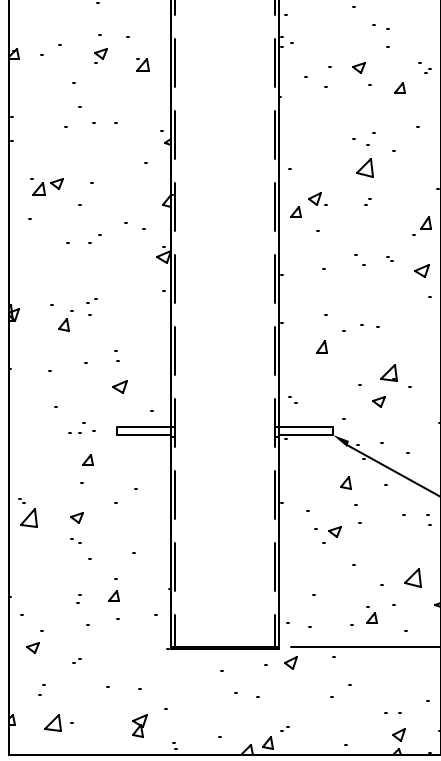

24" SQ.

□ S-1 EMBEDDED

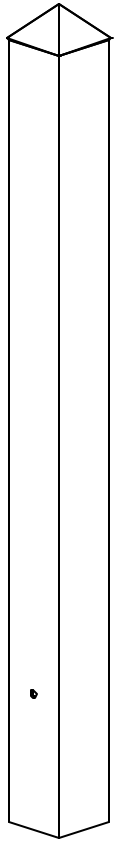

3/8" THK PLATE

11/16" DIA.
ANCHOR HOLES

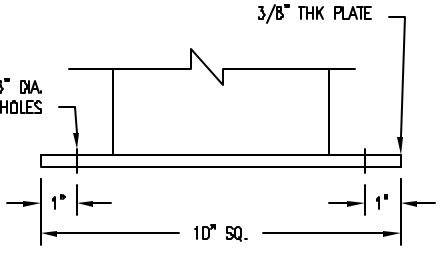

□ S-2 SURFACE MT

NOTES

- 1.) STL MEMBERS COATED W/ ZINC RICH EPOXY THEN FINISHED W/ POLYESTER POWDER COATING.
- 2.) 1/2" X 3 3/4" EXPANSION ANCHOR BOLTS PROVIDED FOR S-2 OPTION.

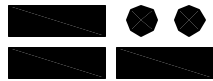

DuMor, inc.

P.O. Box 142 Mifflintown, PA 17059-0142

SCALE :	NONE
DATE DRAWN :	10/24/05
DRAWN BY :	AWH
DATE REV. :	
REV. BY :	

TITLE :	BOLLARD	
REV.	DRAWING NUMBER	SHEET
A	402-36	1 OF 2

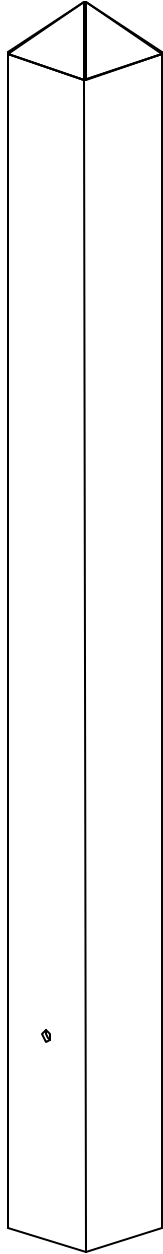

NOTES:

1. MOUNT AND ANCHOR AS SPECIFIED.



DuMor, inc.

P.O. Box 142 Mifflintown, PA 17059-0142

SCALE :	NONE
DATE DRAWN :	10/24/05
DRAWN BY :	AWH
DATE REV. :	
REV. BY :	

TITLE :	BOLLARD		
REV.	DRAWING NUMBER		SHEET
A	402-36		2 OF 2