

LENGTH OPTIONS

- 6' BENCH
- 8' BENCH

NOTES:

- 1.) ALL STL. MEMBERS COATED W/ ZINC RICH EPOXY THEN FINISHED W/ POLYESTER POWDER COATING.
- 2.) 1/2" X 3 3/4" EXPANSION ANCHOR BOLTS PROVIDED.

DuMor, inc.
P.O. Box 142 Mifflintown, PA 17059-0142

SCALE :	NONE
DATE DRAWN :	12/12/96
DRAWN BY :	AH
DATE REV. :	3/11/05
REV. BY :	AWH

TITLE :	BENCH		
REV.	D	DRAWING NUMBER	106 SERIES
			SHEET 1 OF 2

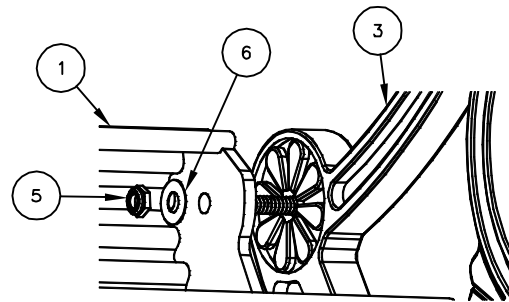
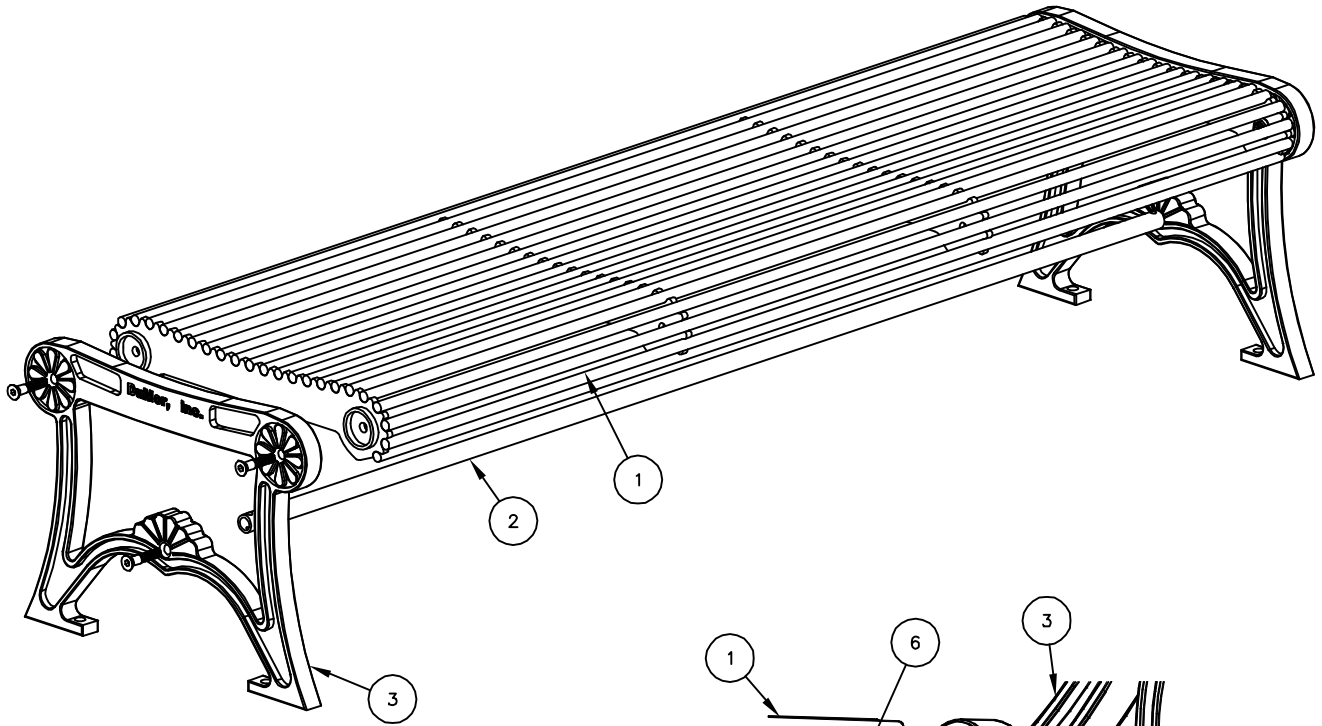

BOLTING DETAIL

NOTE:

- 1.) DURING ASSEMBLY PROCEDURE;
DO NOT COMPLETELY TIGHTEN HARDWARE.
- 2.) THE ACTUAL PARTS WILL NOT BE NUMBERED
NUMBERS ONLY APPLY TO DRAWING.

STEP 1:

- USE 1 - PC. 6' SEAT ASSEMBLY (1)
- 2 - PCS. CAST IRON BENCH SUPPORT (3)
- 4 - PCS. 1/2" X 2 1/2" SS FLT. SKT. HD CAP SCR. (4)
- 4 - PCS. 1/2" SS THIN NYLON LOCKNUT (5)
- 4 - PCS. 1/2" SS FLAT WASHER (6)

ATTACH CAST IRON BENCH SUPPORT (3) TO 6' SEAT ASSEMBLY (1) USING 1/2" X 2 1/2" SS. FLT. SKT. HD. CAP SCR. (4) & 1/2" SS. FLT WASHER (6) & 1/2" SS THIN NYLON LOCKNUT (5). TIGHTEN TO SNUG FIT.

STEP 2:

- USE 1 - PC 71 3/4" PIPE BRACE (2)
 - 2 - PCS. 1/2" X 2 1/2" FLT. SKT. HD. CAP SCR. (4)
- ATTACH 71 3/4" PIPE BRACE (2) TO STEP 1 ASSEMBLY USING HARDWARE (4). TIGHTEN TO SNUG FIT.

STEP 3:

UPON COMPLETION OF BENCH ASSEMBLY SQUARE ALL COMPONENTS THEN TIGHTEN ALL HARDWARE.

STEP 4:

MOUNT AND ANCHOR AS SPECIFIED.

ITEM	QTY	PART NO	DESCRIPTION
1	1	0-106-60-01	6' STL BKLS SEAT SECTION
2	1	0-57-60-04	71 3/4" PIPE BRACE
3	2	0-91-00-02	BKLESS CAST IRON BNCH SUPT
4	6	1-12-065	1/2" X 2 1/2" FLT SKT HD CAP SCR
5	4	1-20-018	1/2" SS THIN NYLON LOCKNUT
6	4	1-22-015	1/2" SS FLAT WASHER

DuMor, inc.
P.O. Box 142 Mifflintown, PA 17059-0142

SCALE : NONE
DATE DRAWN : 12/12/96
DRAWN BY : AH
DATE REV. : 3/11/05
REV. BY : AWH

TITLE : BENCH ASSEMBLY

REV. D DRAWING NUMBER 106 SERIES

SHEET 2 OF 2