

**NOTES**

- 1.) ALL STL. MEMBERS COATED W/ ZINC RICH EPOXY THEN FINISHED W/ POLYESTER POWDER COATING.
- 2.)  $1/2$ " X  $3 \frac{3}{4}$ " EXPANSION ANCHOR BOLTS PROVIDED.
- 3.) CUSTOM LETTERING AVAILABLE FOR RECESSED SIDE PANELS ( TOTAL OF 37 SPACES )

CUSTOM LETTERING ( 37 SPACES )

**LENGTH OPTIONS**

- 6' BENCH
- 8' BENCH

**DuMor, inc.**  
P.O. Box 142 Mifflintown, PA 17059-0142

SCALE : NONE  
 DATE DRAWN : 7/10/01  
 DRAWN BY : AH  
 DATE REV. : 5/11/05  
 REV. BY : AWH

TITLE : BENCH  
 PATENT D467-101

REV. C  
 DRAWING NUMBER 141 SERIES

SHEET 1 OF 2

**NOTE:**

- 1.) DURING ASSEMBLY PROCEDURE;  
DO NOT COMPLETELY TIGHTEN HARDWARE.
- 2.) THE ACTUAL PARTS WILL NOT BE NUMBERED:  
NUMBERS ONLY APPLY TO DRAWING.

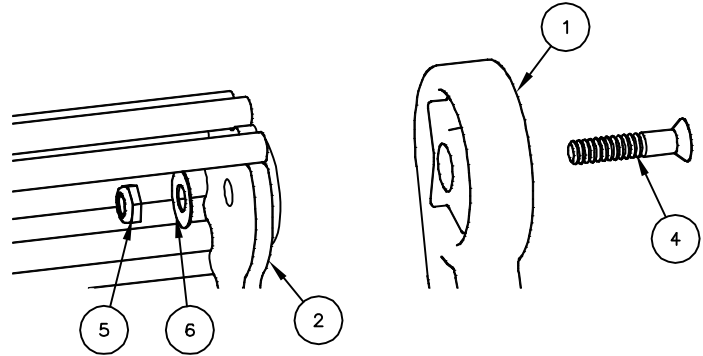
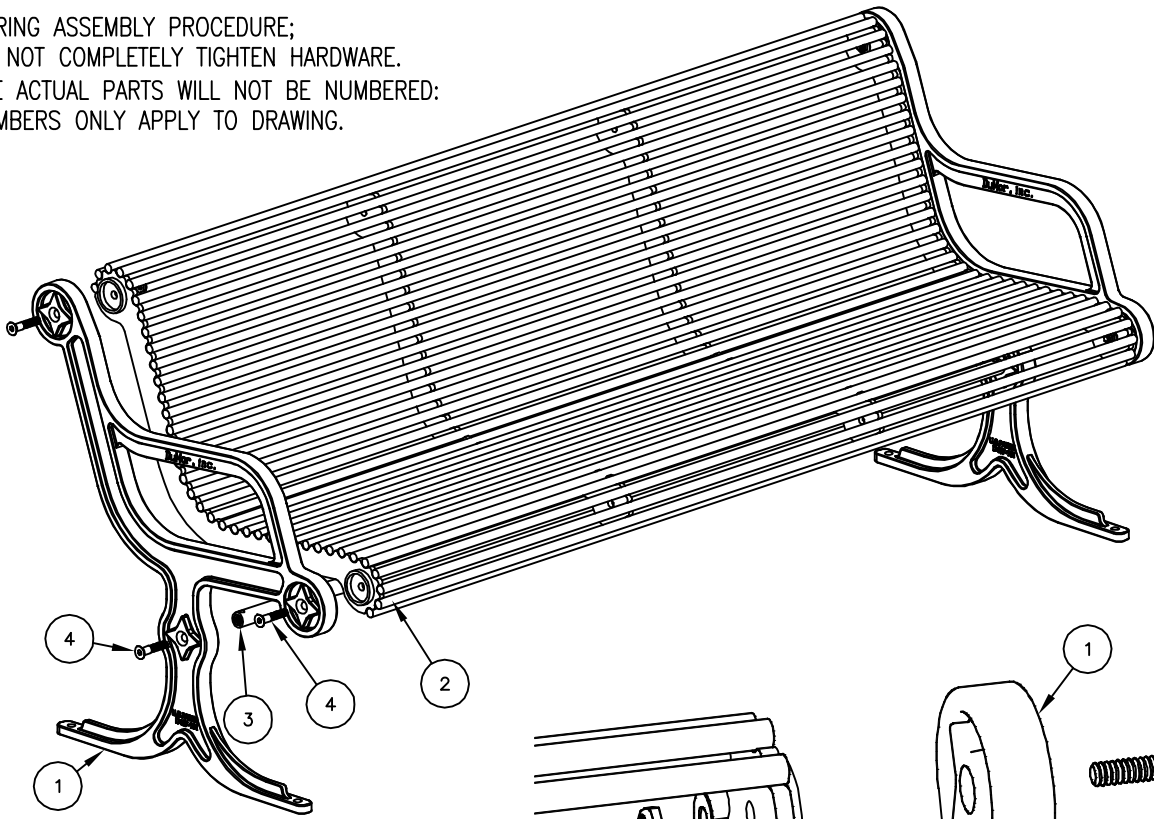

**BOLTING DETAIL**

**STEP 1:**

- USE 1 – PC. 6’ SEAT ASSEMBLY ( 2 )
- 2 – PCS. CAST IRON BENCH SUPPORTS ( 1 )
- 4 – PCS. 1/2” X 2 1/2” FLT. SKT. HD. CAP SCR. ( 4 )
- 4 – PCS. 1/2” SS. THIN NYLON LOCKNUT ( 5 )
- 4 – PCS. 1/2” SS FLAT WASHER ( 6 )

ATTACH CAST IRON BENCH SUPPORT ( 1 ) TO 6’ SEAT ASSEMBLY ( 2 ) USING HARDWARE ( 4, 5, & 6 ). TIGHTEN TO SNUG FIT.

**STEP 2:**

- USE 1 – PC. 71 3/4” PIPE BRACE ( 3 )
  - 2 – PCS. 1/2” X 2 1/2” FLT. SKT. HD. CAP SCR ( 4 )
- ATTACH 71 3/4” PIPE BRACE ( 3 ) TO STEP 1 ASSEMBLY USING HARDWARE ( 4 ). TIGHTEN SNUG FIT.

**STEP 3:**

UPON COMPLETION OF BENCH ASSEMBLY SQUARE ALL COMPONENTS THEN TIGHTEN ALL HARDWARE.

**STEP 4:**

MOUNT AND ANCHOR AS SPECIFIED.

ITEM	QTY	PART NO	DESCRIPTION
1	2	0-140-00-01	CAST IRON BENCH SUPPORT
2	1	0-19-60-01	6’ STL SEAT SECTION
3	1	0-57-60-04	71 3/4” PIPE BRACE
4	6	1-12-065	1/2” X 2 1/2” FLT SKT HD CAP SCR
5	4	1-20-018	1/2” SS THIN NYLON LOCKNUT
6	4	1-22-015	1/2” SS FLAT WASHER

**DuMor, inc.**  
P.O. Box 142 Mifflintown, PA 17059-0142

SCALE : NONE  
DATE DRAWN : 7/10/01  
DRAWN BY : AWH  
DATE REV. : 3/11/05  
REV. BY : AWH

TITLE : BENCH ASSEMBLY  
PATENT D467-101

REV. C DRAWING NUMBER 141 SERIES SHEET 2 OF 2