

NOTES

- 1.) ALL STL. MEMBERS COATED W/ ZINC RICH EPOXY THEN FINISHED W/ POLYESTER POWDER COATING.
- 2.) 1/2" X 3 3/4" EXPANSION ANCHOR BOLTS PROVIDED.

WOOD OPTIONS

- 'C' & BTR. DOUGLAS FIR KD S4S EE
- IPE S4S EE
- OTHER _____

PARTS LIST

ITEM	QTY	PART NO	DESCRIPTION
1	6	0-460-00-02	CONTOUR STRAP
2	1	0-460-00L-01	LEFT BENCH SUPPORT
3	1	0-460-00R-01	RIGHT BENCH SUPPORT
4	4	0-460-60-03	71 3/4" ALUM EXTRUSION
5	6	0-57-60-01	2" X 3" X 71" WOOD INT'R SLAT
6	8	1-12-053	5/16" X 1 1/2" SS BTN SKT HD CAP SCR
7	18	1-13-023	5/16" X 1 1/2" SS BTN SKT HD LAG
8	18	1-22-017	5/16" SS FLAT WASHER

KITS PROVIDED

ITEM	QTY	PART NO	DESCRIPTION
9	1	K-ANCO860-4	1/2" X 3 3/4" SS ANCHOR KIT (4PC)
10	1	K-BC0524-8	5/16" CAP HARDWARE KIT (8PC)
11	1	K-BL0524-18	5/16" LAG HARDWARE KIT (18PC)

NOTE:

- 1.) DURING ASSEMBLY PROCEDURE; DO NOT COMPLETELY TIGHTEN HARDWARE.
- 2.) THE ACTUAL PARTS WILL NOT BE NUMBERED. NUMBERS ONLY APPLY TO DRAWING.
- 3.) UPON COMPLETION OF ASSEMBLY SQUARE ALL COMPONENTS THEN TIGHTEN ALL HARDWARE.
- 4.) MOUNT AND ANCHOR AS SPECIFIED.

TOOLS REQ'D

- 3/4" WRENCH
 1/4" ALLEN WRENCH
 3/16" ALLEN WRENCH
 1/2" MASONRY DRILL BIT
 DRILL

1 ATTACH SLATS TO CONTOUR STRAPS.

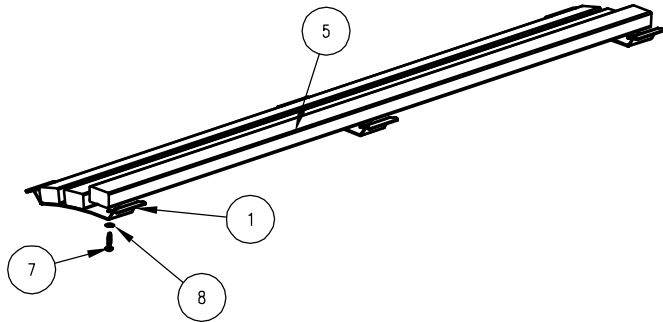

2 ATTACH 2 ALUM. EXTRUSIONS AS SHOWN, TO LEFT & RIGHT BENCH SUPPORTS, ENSURE PINS ARE IN "L" SLOTS.

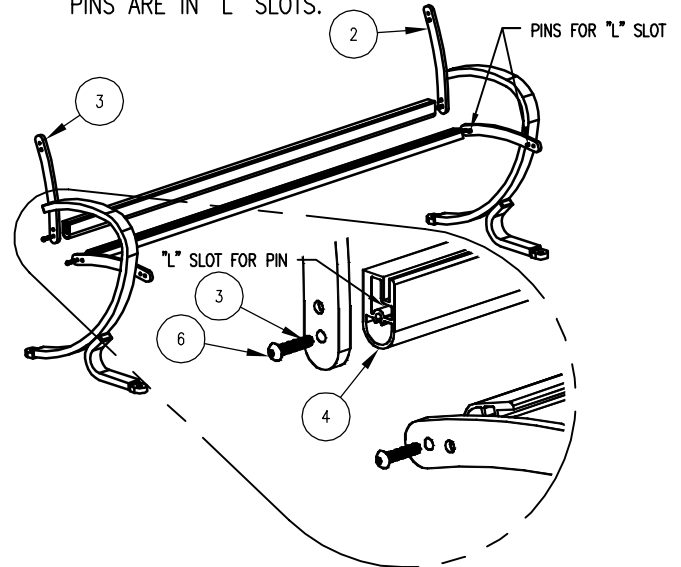

3 INSERT STEP 1 INTO STEP 2, USING SLOTS ON ALUM. EXTRUSION.
 NOTE: RIGHT BENCH SUPPORT NOT SHOWN FOR CLARITY.

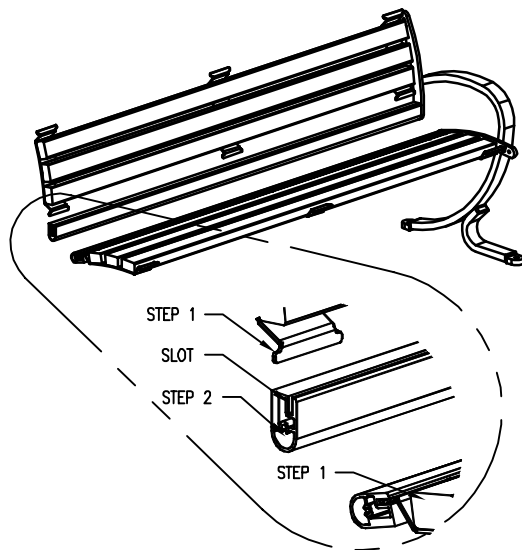

4 ATTACH 2 REMAINING ALUM. EXTRUSIONS TO SUPPORTS, AS IN STEP 2.

