

S-2 SURFACE

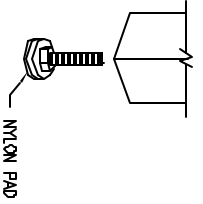

S-5 FREE STANDING

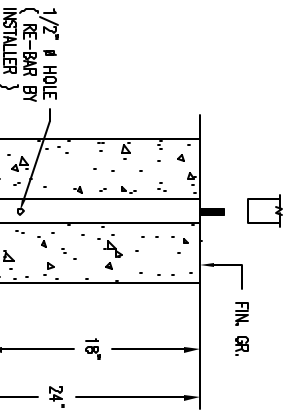

S-1 EMBEDMENT

- NOTES:
- 1.) ALL STL MEMBERS COATED W/ ZINC RICH EPOXY THEN FINISHED W/ POLYESTER POWDER COATING.
 - 2.) ALL WELDS CONT. THEN GROUND SMOOTH.
 - 3.) BENCH SHIPPED UNASSEMBLED.
 - 4.) 1/2" X 3 3/4" PLTD. EXPANSION ANCHOR BOLTS PROVIDED FOR S-2 OPTION.

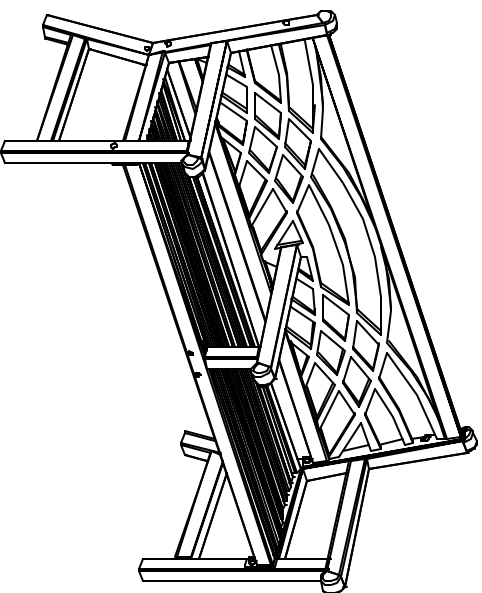

DATE DRAWN : 4/5/98
DRAWN BY : HD
DATE REV. : 4/7/03
REV. BY : CDC

TITLE	BENCH
REVISION	B
DRAWING NUMBER	94-60-3AR