

NOTES:

- 1.) ALL STL. MEMBERS COATED W/ ZINC RICH EPOXY THEN FINISHED W/ POLYESTER POWDER COATING.
- 2.) 1/2" X 1 1/2" NYLON GLIDES & 1/2" X 3 3/4" EXPANSION ANCHOR BOLTS W/ S-2 PLATES PROVIDED.



DuMor, inc.

P.O. Box 142 Mifflintown, PA 17059-0142

SCALE : NONE
 DATE DRAWN : 9/11/12
 DRAWN BY : JSB
 DATE REV. :
 REV. BY :

TITLE : TABLE

REV. A

DRAWING NUMBER 445-14

SHEET 1 OF 2

NOTES:

- 1.) DURING ASSEMBLY PROCEDURE;
DO NOT COMPLETELY TIGHTEN HARDWARE.
- 2.) THE ACTUAL PARTS WILL NOT BE NUMBERED;
NUMBERS ONLY APPLY TO DRAWING.

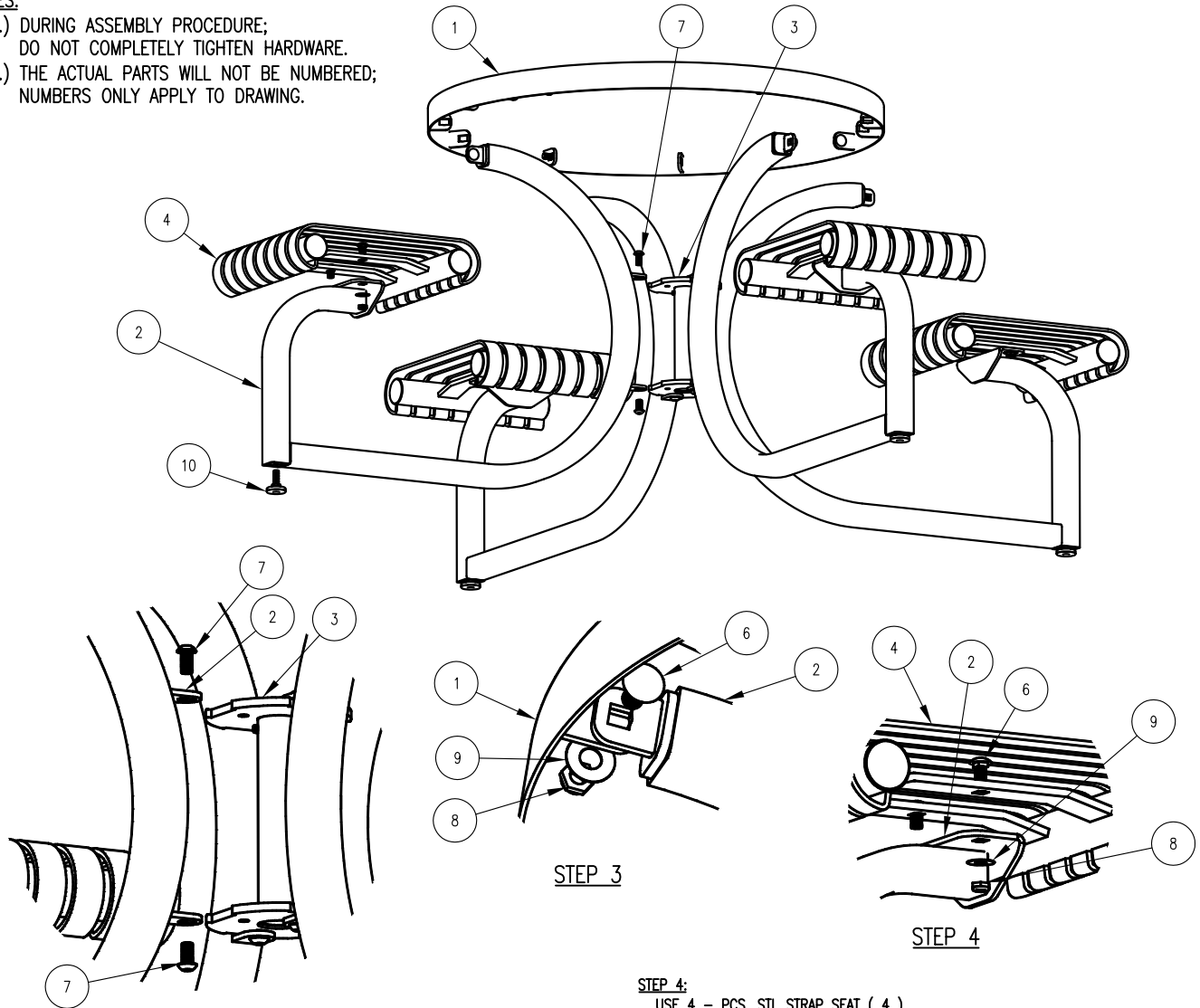

STEP 2

STEP 3

STEP 4

STEP 1:

- USE 4 - PCS. TABLE SUPPORT LEG (2)
 - 4 - PCS. SURFACE MOUNT FOOT PAD (5)
 - 4 - PCS. 1/2" X 1 1/2" SWIVEL GLIDE (10)
- ATTACH SURFACE MOUNT FOOT PAD (5) OR 1/2" X 1 1/2" SWIVEL GLIDE (10) TO TABLE SUPPORT LEG (2) REPEAT UNTIL ALL SURFACE MOUNT FOOT PAD OR GLIDES ARE ATTACHED.

STEP 2:

- USE 1 - PC. 4 SEAT BOLTING COLLAR (3)
 - 8 - PCS. 1/2" X 1" SS BTN SKT HD CAP SCR (7)
- ATTACH STEP 1 ASSEMBLY TO 4 SEAT BOLTING COLLAR (3) USING HARDWARE (7). TIGHTEN TO SNUG FIT. REPEAT UNTIL ALL STEP 1 ASSEMBLY ATTACHED.

STEP 3:

- USE 1 - PC. STL TABLE TOP (1)
 - 4 - PCS. 1/2" X 1" SS CGE BOLT (6)
 - 4 - PCS. 1/2" SS. THIN LOCKNUT (8)
 - 4 - PCS. 1/2" SS. FLAT WASHER (9)
- ATTACH STL TABLE TOP (1) TO STEP 2 ASSEMBLY USING HARDWARE (6, 8 & 9). TIGHTEN TO SNUG FIT.

STEP 4:

- USE 4 - PCS. STL STRAP SEAT (4)
 - 8 - PCS. 1/2" X 1" SS CGE BOLT (6)
 - 8 - PCS. 1/2" SS. THIN LOCKNUT (8)
 - 8 - PCS. 1/2" SS. FLAT WASHER (9)
- ATTACH STL STRAP SEAT (4) TO STEP 3 ASSEMBLY USING HARDWARE (6, 8 & 9). TIGHTEN TO SNUG FIT. REPEAT UNTIL ALL STL STRAP SEATS ARE ATTACHED.

STEP 5:

UPON COMPLETION OF TABLE ASSEMBLY SQUARE ALL COMPONENTS THEN TIGHTEN ALL HARDWARE.

| ITEM | QTY | PART NO | DESCRIPTION |
|------|-----|----------------|---------------------------------|
| 1 | 1 | 0-445-00-01 | STL TABLE TOP |
| 2 | 4 | 0-445-00-02 | TABLE SUPPORT LEG |
| 3 | 1 | 0-445-04-03 | 4 SEAT BOLTING COLLAR |
| 4 | 4 | 0-445-10-04 | STL STRAP SEAT |
| 5 | 4 | 0-94-00-02/S-2 | SURFACE MOUNT FOOT PAD, PC |
| 6 | 12 | 1-11-068 | 1/2" X 1" SS CGE BOLT |
| 7 | 8 | 1-12-056 | 1/2" X 1" SS BTN SKT HD CAP SCR |
| 8 | 12 | 1-20-018 | 1/2" SS THIN NYLON LOCKNUT |
| 9 | 12 | 1-22-015 | 1/2" SS FLAT WASHER |
| 10 | 4 | 5-48-078 | 1/2" X 1 1/2" SWIVEL GLIDE |

DuMor, inc.
P.O. Box 142 Mifflintown, PA 17059-0142

SCALE : NONE
DATE DRAWN : 9/11/12
DRAWN BY : JSB
DATE REV. :
REV. BY :

TITLE : TABLE ASSEMBLY
REV. A
DRAWING NUMBER 445-14
SHEET 2 OF 2