

LENGTH OPTIONS

- 6' BENCH
- 8' BENCH

NOTES

1.) ALL STL. MEMBERS COATED W/ ZINC RICH EPOXY THEN FINISHED W/ POLYESTER POWDER COATING.

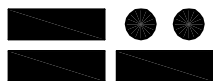

DuMor, inc.

P.O. Box 142 Mifflintown, PA 17059-0142

SCALE :	NONE
DATE DRAWN :	3/22/94
DRAWN BY :	AH
DATE REV. :	12/3/99
REV. BY :	JSB

TITLE : TEAM BENCH

REV. C

DRAWING NUMBER 97 SERIES A /S-1

SHEET 1 OF 2

NOTE:

- 1.) DURING ASSEMBLY PROCEDURE;
DO NOT COMPLETELY TIGHTEN HARDWARE.
- 2.) THE ACTUAL PARTS WILL NOT BE NUMBERED:
NUMBERS ONLY APPLY TO DRAWING.

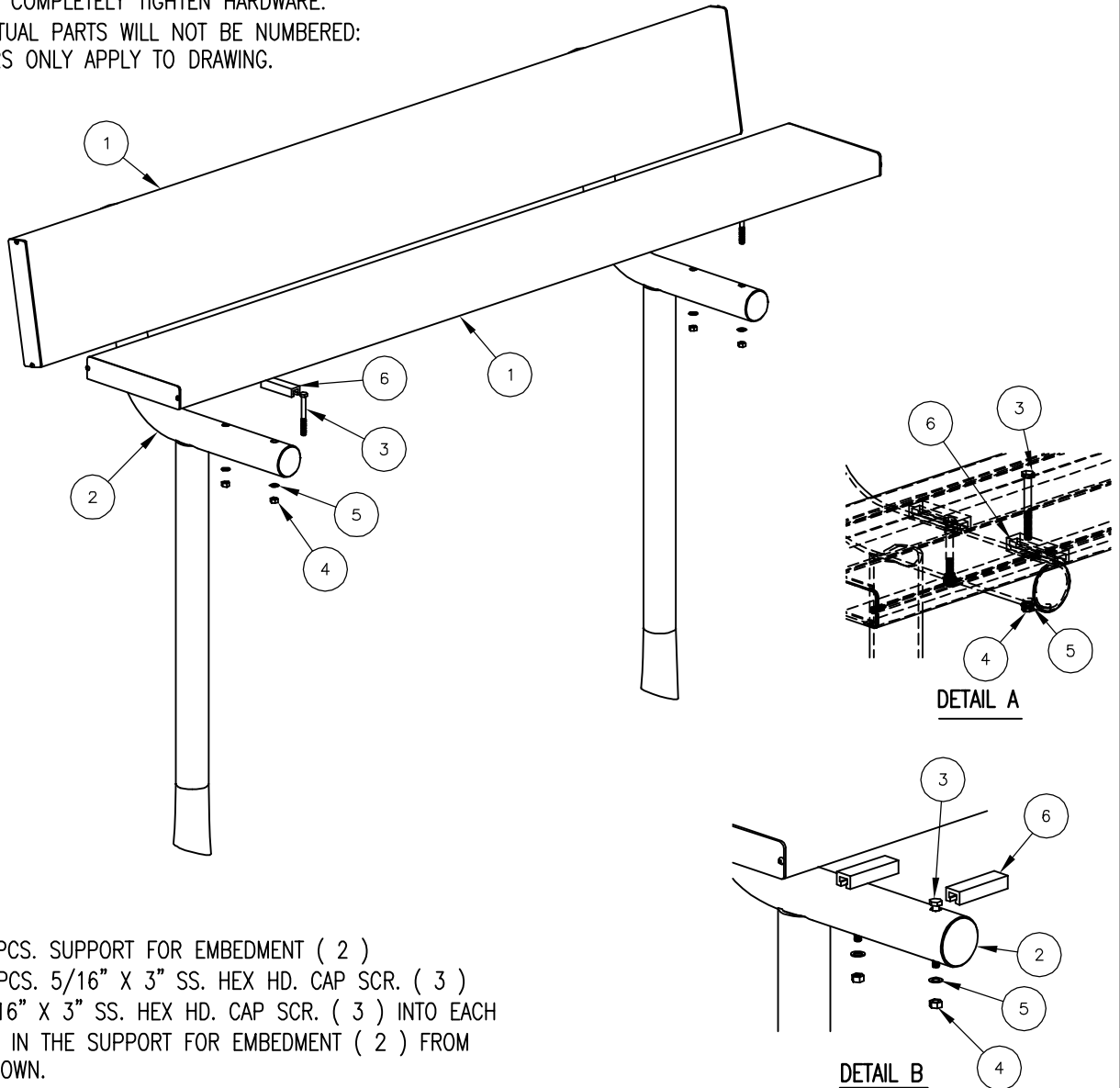

STEP 1:

USE 2 - PCS. SUPPORT FOR EMBEDMENT (2)
 8 - PCS. 5/16" X 3" SS. HEX HD. CAP SCR. (3)
 INSERT 5/16" X 3" SS. HEX HD. CAP SCR. (3) INTO EACH
 BOLT HOLE IN THE SUPPORT FOR EMBEDMENT (2) FROM
 THE TOP DOWN.

STEP 2:

USE 2 - PCS. 2" X 10" X 6' ALUMINUM PLANK (1)
 8 - PCS. ALUMINUM CLIPS (6)
 8 - PCS. 5/16" SS. HEX NUT (4)
 8 - PCS. 3/8" ID. X 5/8" OD. RUBBER WASHER (5)
 SLIDE ALUMINUM CLIP (6) OVER HEAD OF 5/16" X 3"
 S.STL. HEX HD. CAP SCR. (3). PLACE 2" X 10" X 6'
 ALUMINUM PLANK (1) ON SUPPORT OVER TOP OF ALUMINUM
 CLIP. TURN CLIP 1/4 TURN IN ALUMINUM PLANK TO LOCK INTO
 PLACE. THEN USE HARDWARE (4 & 5) TO TIGHTEN TO SNUG
 FIT.

STEP 3:

UPON COMPLETION OF BENCH ASSEMBLY SQUARE ALL
 COMPONENTS THEN TIGHTEN ALL HARDWARE.

STEP 4:

MOUNT AND ANCHOR AS SPECIFIED.

ITEM	QTY	PART NO	DESCRIPTION
1	2	0-71-60A-01	2" X 10" X 6' ALUMINUM PLANK
2	2	0-97-00-01/S-1	SUPPORT FOR EMBEDMENT
3	8	1-12-076	5/16" X 3" S.STL. HEX HD CAP SCR
4	8	1-21-015	5/16" SS HEX NUT
5	8	1-22-018	3/8" ID X 5/8" OD RUBBER WASHER
6	8	5-48-083	ALUMINUM CLIPS

DuMor, inc.
 P.O. Box 142 Mifflintown, PA 17059-0142

SCALE : NONE
 DATE DRAWN : 12/3/99
 DRAWN BY : JSB
 DATE REV. : 12/3/99
 REV. BY : JSB

TITLE : BENCH ASSEMBLY
 REV. C
 DRAWING NUMBER 97 SERIES A /S-1
 SHEET 2 OF 2