

**NOTES:**

- 1.) ALL STL. MEMBERS COATED W/ ZINC RICH EPOXY THEN FINISHED W/ POLYESTER POWDER COATING.
- 2.) 1/2" X 3 3/4" EXPANSION ANCHOR BOLTS PROVIDED.

**SLAT OPTIONS**

- "CEDAR" RECYCLED PLASTIC
- "GREEN" RECYCLED PLASTIC
- "GREY" RECYCLED PLASTIC
- "REDWOOD" RECYCLED PLASTIC
- "WALNUT" RECYCLED PLASTIC
- OTHER \_\_\_\_\_

**DuMor, inc.**  
P.O. Box 142 Mifflintown, PA 17059-0142

SCALE : NONE  
DATE DRAWN : 12/11/01  
DRAWN BY : AWH  
DATE REV. : 12/03/09  
REV. BY : ESS

TITLE : BENCH

REV. D

DRAWING NUMBER

91-60PL

SHEET 1 OF 2

**NOTE:**

- 1.) DURING ASSEMBLY PROCEDURE;  
DO NOT COMPLETELY TIGHTEN HARDWARE.
- 2.) THE ACTUAL PARTS WILL NOT BE NUMBERED,  
NUMBERS ONLY APPLY TO DRAWING.

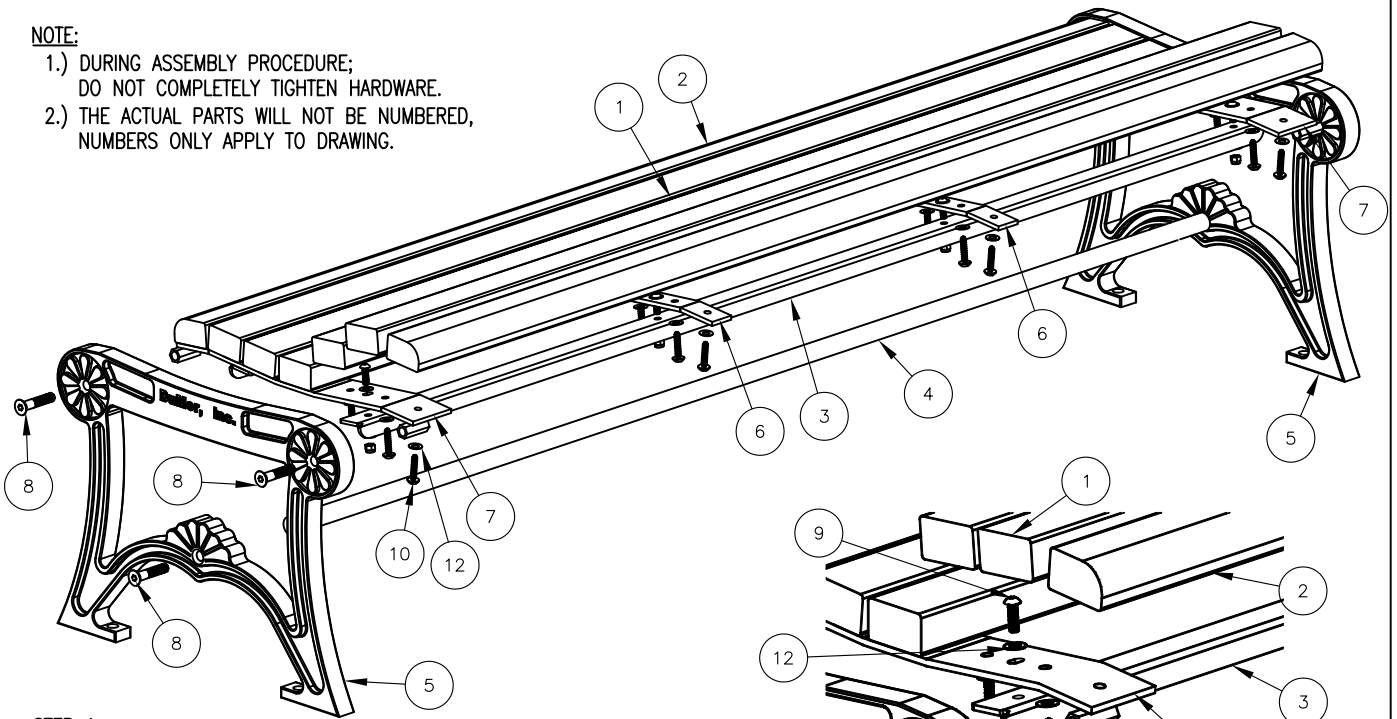

**STEP 1:**

- USE 2 - PCS. CAST IRON SUPPORT ( 5 )
  - 1 - PC. 71 3/4" PIPE BRACE ( 4 )
  - 2 - 1/2" X 2 1/2" FLT. SKT. HD. CAP SCR. ( 8 )
- ATTACH CAST IRON SUPPORT ( 5 ) TO 71 3/4" PIPE BRACE ( 4 ) USING HARDWARE ( 8 ). TIGHTEN TO SNUG FIT.

**STEP 2:**

- USE 2 - PCS. END STRAP ( 7 )
  - 4 - PCS. 1/2" X 2 1/2" FLT. SKT. HD. CAP SCR. ( 8 )
- ATTACH END STRAP ( 7 ) TO STEP 1 ASSEMBLY USING HARDWARE ( 8 ). TIGHTEN TO SNUG FIT.

**STEP 3:**

- USE 2 - PCS. 71" SEAT BRACE ( 3 )
  - 4 - PCS. 5/16" X 1" SS. BTN SKT HD CAP SCR ( 9 )
  - 4 - PCS. 5/16" SS. NYLON LOCK NUT ( 11 )
  - 8 - PCS. 5/16" SS. FLAT WASHER ( 12 )
- ATTACH 71" SEAT BRACE ( 3 ) TO STEP 2 ASSEMBLY USING HARDWARE ( 9, 11, & 12 ). TIGHTEN TO SNUG FIT.

**STEP 4:**

- USE 2 - PCS. CENTER STRAP ( 6 )
  - 4 - PCS. 5/16" X 1" SS. BTN SKT HD CAP SCR ( 9 )
  - 4 - PCS. 5/16" SS. NYLON LOCK NUT ( 11 )
  - 8 - PCS. 5/16" SS. FLAT WASHER ( 12 )
- ATTACH CENTER STRAP ( 6 ) TO STEP 3 ASSEMBLY USING HARDWARE ( 9, 11, & 12 ). TIGHTEN TO SNUG FIT.

**STEP 5:**

- USE 5 - PCS. 2" X 3" X 71" INT'R PLASTIC SLAT ( 1 )
  - 2 - PCS. 2" X 3" X 71" EDGE PLASTIC SLAT ( 2 )
  - 28 - PCS. 5/16" X 1 1/2" SS. BTN. SKT. HD. LAG ( 10 )
  - 28 - PCS. 5/16" SS. FLAT WASHER ( 12 )
- ATTACH 2" X 3" X 71" PLASTIC SLATS ( 1 & 2 ) TO STEP 4 ASSEMBLY USING HARDWARE ( 10 & 12 ). TIGHTEN TO SNUG FIT. REPEAT UNTIL ALL SLATS ARE ATTACHED.

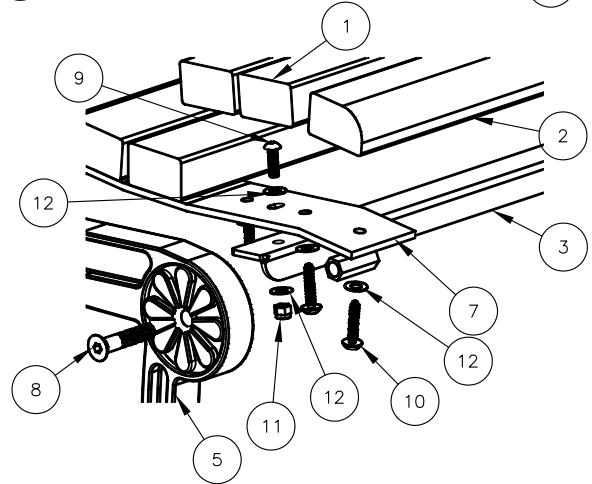

**DETAIL A**

**STEP 6:**

UPON COMPLETION OF BENCH ASSEMBLY SQUARE ALL COMPONENTS THEN TIGHTEN ALL HARDWARE.

**STEP 7:**

MOUNT AND ANCHOR AS SPECIFIED.

ITEM	QTY	PART NO	DESCRIPTION
1	5	0-143-60PL-01	2" X 3" X 71" PLASTIC INT'R SLAT
2	2	0-143-60PL-02	2" X 3" X 71" PLASTIC EDGE SLATS
3	2	0-16-60-06	71" SEAT BRACE
4	1	0-57-60-04	71 3/4" PIPE BRACE
5	2	0-91-00-02	BKLESS CAST IRON BNCH SUPT
6	2	0-91-00-03	CENTER STRAP
7	2	0-91-00-04	END CONTOUR STRAP
8	6	1-12-065	1/2" X 2 1/2" FLT SKT HD CAP SCR
9	8	1-12-116	5/16" X 1" SS BTN SKT HD CAP SCR
10	28	1-13-023	5/16" X 1 1/2" SS BTN SKT HD LAG
11	8	1-20-016	5/16" SS NYLON LOCKNUT
12	44	1-22-017	5/16" SS FLAT WASHER

**DuMor, inc.**  
P.O. Box 142 Mifflintown, PA 17059-0142

SCALE : NONE  
DATE DRAWN : 12/11/01  
DRAWN BY : AWH  
DATE REV. : 12/03/09  
REV. BY : ESS

TITLE : BENCH ASSEMBLY

REV. D	DRAWING NUMBER 91-60PL	SHEET 2 OF 2
--------	------------------------	--------------