

NOTES

- 1.) ALL STL. MEMBERS COATED W/ ZINC RICH EPOXY THEN FINISHED W/ POLYESTER POWDER COATING.
- 2.) 1/2" X 3 3/4" EXPANSION ANCHOR BOLTS PROVIDED.

NOTES:

- 1.) DURING ASSEMBLY PROCEDURE;
DO NOT COMPLETELY TIGHTEN HARDWARE.
- 2.) THE ACTUAL PARTS WILL NOT BE NUMBERED.
NUMBERS ONLY APPLY TO DRAWING.
- 3.) UPON COMPLETION OF ASSEMBLY SQUARE
ALL COMPONENTS THEN TIGHTEN ALL HARDWARE.
- 4.) MOUNT AND ANCHOR AS SPECIFIED.

TOOLS REQ'D

- 3/4" WRENCH
- 3/16" ALLEN WRENCH
- 1/2" MASONRY DRILL BIT
DRILL

PARTS LIST

ITEM	QTY	PART NO	DESCRIPTION
1	4	0-460-60-03	71 3/4" ALUM EXTRUSION
2	6	0-460-60VS-01	10 GA STL PLATE
3	1	0-464-00-01	TABLE SUPPORT
4	4	0-464-20-03	2' TABLE TOP SECTION
5	1	0-464-68-01	WHLCHR TABLE SUPPORT
6	1	0-464-68-04	WHLCHR TABLE END PLATE
7	1	0-464-68L-06	95 3/4" LEFT ALUM EXTRUSION FOR WHLCHR TABLE
8	1	0-464-68R-06	95 3/4" RIGHT ALUM EXTRUSION FOR WHLCHR TABLE
9	12	1-12-053	5/16" X 1 1/2" SS BTN SKT HD CAP SCR
10	4	1-12-116	5/16" X 1" SS BTN SKT HD CAP SCR

KITS PROVIDED

ITEM	QTY	PART NO	DESCRIPTION
11	1	K-ANC0860-4	1/2" X 3 3/4" SS ANCHOR KIT (4PC)
12	1	K-BC0516-4	5/16" CAP HARDWARE KIT (4PC)
13	2	K-BC0524-6	5/16" CAP HARDWARE KIT (6PC)

- 1** ATTACH 3 ALUM. EXTRUSIONS AS SHOWN, TO LEFT & RIGHT TABLE SUPPORTS, ENSURE PINS ARE IN "L" SLOTS.

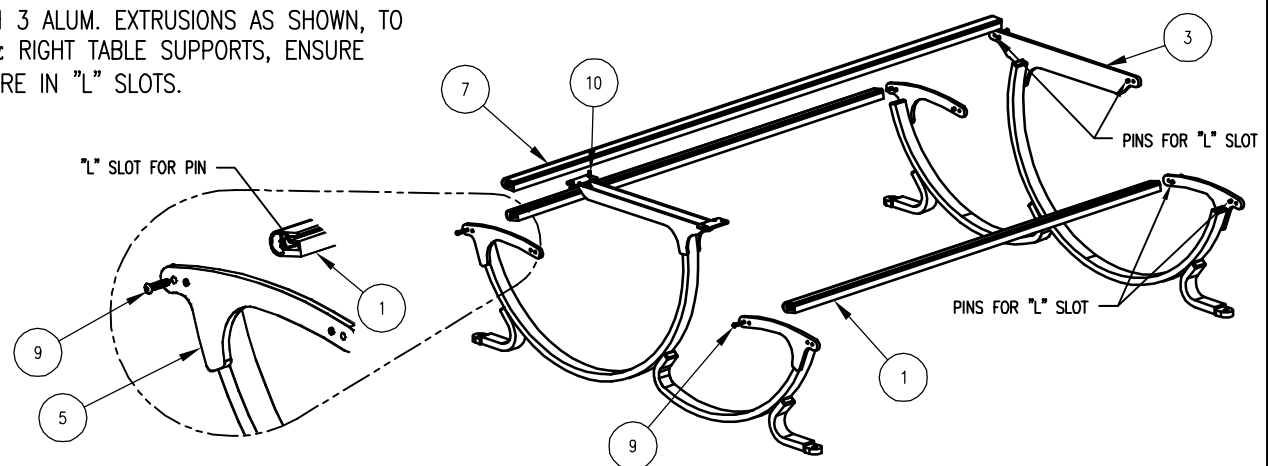

- 2** INSERT SEATS & TABLE TOP INTO STEP 1, USING SLOTS ON ALUM. EXTRUSIONS.

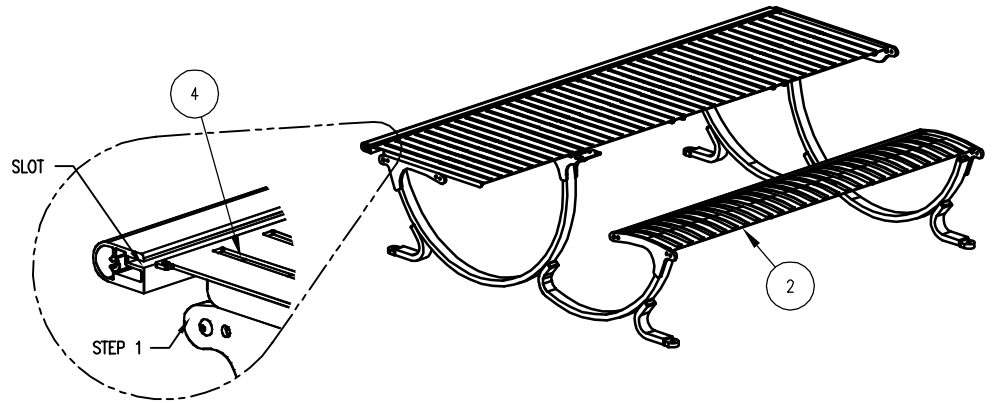

- 3** ATTACH 3 REMAINING ALUM. EXTRUSIONS & END PLATE TO SUPPORTS, AS IN STEP 1. UPON COMPLETION OF TABLE ASSEMBLY SQUARE ALL COMPONENTS THEN TIGHTEN ALL HARDWARE.

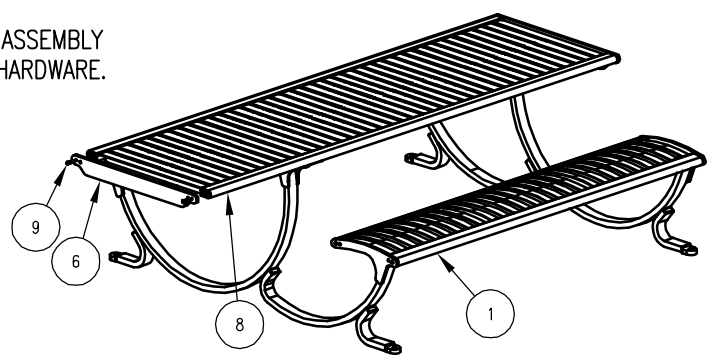

ASSEMBLY INSTRUCTIONS

DATE DRAWN : 9/23/15
 DRAWN BY : ESS
 DATE REV. : 11/5/15
 REV. BY : JSB

REV. B

DRAWING NUMBER

464-68VS

SHEET 2 OF 2