

SLAT OPTIONS

- "CEDAR" RECYCLED PLASTIC
- "GREY" RECYCLED PLASTIC
- "REDWOOD" RECYCLED PLASTIC
- "WALNUT" RECYCLED PLASTIC
- OTHER _____

LENGTH OPTIONS

- 6' TABLE
- 8' TABLE

FINISH OPTIONS

- MILL FINISH (STANDARD)
- COATED (OPTIONAL - UPCHARGE APPLIES PLEASE CONSULT YOUR LOCAL REPRESENTATIVE)

NOTES:

1.) 1/4" X 1 1/2" HAMMER SET ANCHORS PROVIDED.

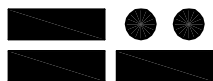

DuMor, inc.

P.O. Box 142 Mifflintown, PA 17059-0142

SCALE : NONE
 DATE DRAWN : 11/22/02
 DRAWN BY : JSB
 DATE REV. : 10/27/11
 REV. BY : RDH

TITLE : PICNIC TABLE

REV. E

DRAWING NUMBER 156 SERIES PL

SHEET 1 OF 2

NOTE:

- 1.) DURING ASSEMBLY PROCEDURE;
DO NOT COMPLETELY TIGHTEN HARDWARE.
- 2.) THE ACTUAL PARTS WILL NOT BE NUMBERED;
NUMBERS ONLY APPLY TO DRAWING.

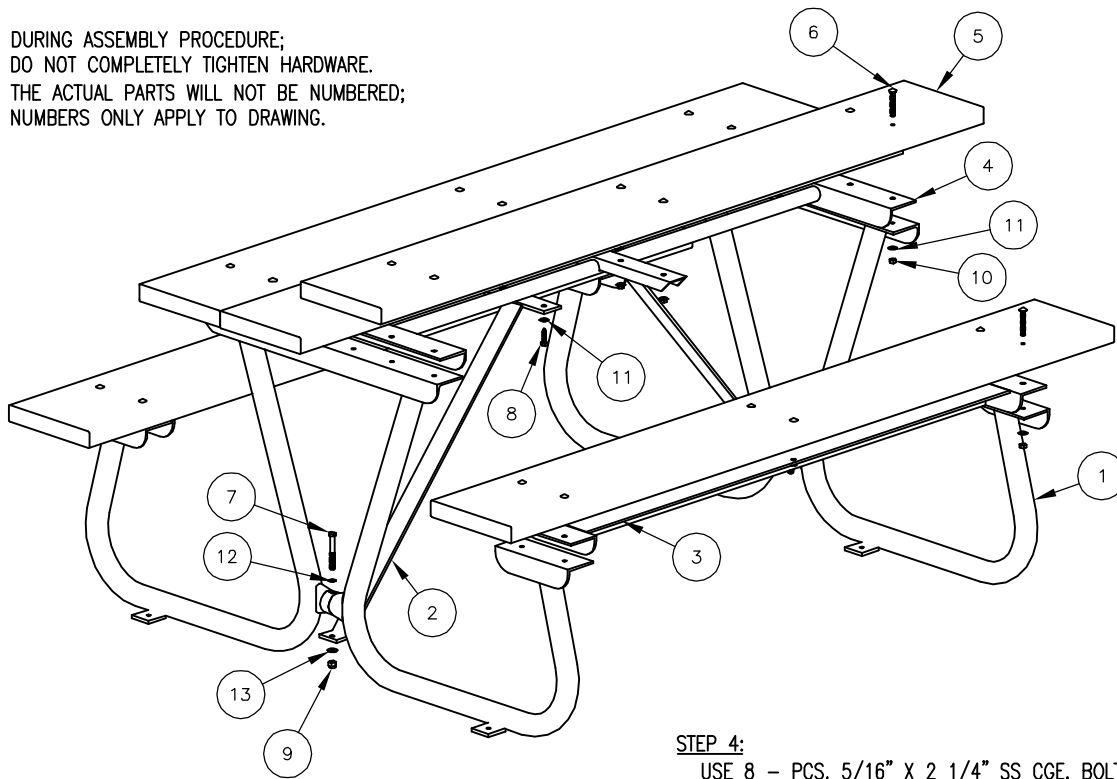

STEP 1:

- USE 3 - PCS. 2" X 10" X 71" PLASTIC SLATS (5)
 1 - PC. 6' ALUM TABLE TOP BRACE (4)
 6 - PCS. 5/16" X 2 1/4" SS CGE. BOLT (6)
 6 - PCS. 5/16" SS HEX NUT (10)
 6 - PCS. 5/16" SS FLAT WASHER (11)
 ATTACH 2" X 10" X 71" PLASTIC SLATS (5) TO CENTER OF 6' TABLE TOP BRACE (4) USING HARDWARE (6, 10, & 11). TIGHTEN TO SNUG FIT. REPEAT UNTIL ALL SLATS ARE ATTACHED.

STEP 2:

- USE 2 - PCS. ALUM END SUPPORT FRAME (1)
 12 - PCS. 5/16" X 2 1/4" SS CGE. BOLT (6)
 12 - PCS. 5/16" SS HEX NUT (10)
 12 - PCS. 5/16" SS FLAT WASHER (11)
 ATTACH STEP 1 ASSEMBLY TO END SUPPORT FRAME (1) USING HARDWARE (6, 10, & 11). TIGHTEN TO SNUG FIT.

STEP 3:

- USE 2 - PCS. 2" X 10" X 71" PLASTIC SLATS (5)
 2 - PCS. 6' ALUM SEAT BRACE (3)
 4 - PCS. 5/16" X 2 1/4" SS CGE. BOLT (6)
 4 - PCS. 5/16" SS HEX NUT (10)
 4 - PCS. 5/16" SS FLAT WASHER (11)
 ATTACH 2" X 10" X 71" PLASTIC SLATS (5) TO CENTER OF 6' ALUM SEAT BRACE (3) USING HARDWARE (6, 10, & 11). TIGHTEN TO SNUG FIT.

STEP 4:

- USE 8 - PCS. 5/16" X 2 1/4" SS CGE. BOLT (6)
 8 - PCS. 5/16" SS HEX NUT (10)
 8 - PCS. 5/16" SS FLAT WASHER (11)
 ATTACH STEP 3 ASSEMBLY TO STEP 2 ASSEMBLY USING HARDWARE (6, 10, & 11). TIGHTEN TO SNUG FIT.

STEP 5:

- USE 2 - PCS. ALUM "T" BRACE (2)
 2 - PCS. 3/8" X 3" SS HEX HD CAP SCR. (7)
 4 - PCS. 5/16" X 1 1/4" SS HEX HD LAG SCR. (8)
 2 - PCS. 3/8" SS NYLON LOCK NUT (9)
 4 - PCS. 5/16" SS FLAT WASHER (11)
 2 - PCS. 3/8" ID X 5/8" OD RUBBER WASHER (12)
 2 - PCS. 3/8" SS FLAT WASHER (13)
 SQUARE STEP 4 ASSEMBLY THEN ATTACH ALUM "T" BRACE (2) USING HARDWARE (7, 8, 9, 11, 12, & 13). NO PILOT HOLES FOR 5/16" X 1 1/4" SS HEX HD LAG SCR. (8).

STEP 6:

UPON COMPLETION OF TABLE ASSEMBLY TIGHTEN ALL HARDWARE.

ITEM	QTY	PART NO	DESCRIPTION
1	2	0-156-00-01	ALUM END SUPPORT FRAME
2	2	0-156-00-02	ALUM "T" BRACE
3	2	0-156-60-14	6' ALUM TABLE TOP BRACE
4	1	0-156-60-15	6' ALUM TABLE TOP BRACE
5	5	0-71-60PL-01	2" X 10" X 71" PLASTIC SLAT
6	30	1-11-062	5/16" X 2 1/4" SS CGE BOLT
7	2	1-12-002	3/8" X 3" SS HEX HD CAP SCR
8	4	1-13-001	5/16" X 1 1/4" SS HEX HD LAG SCR
9	2	1-20-007	3/8" SS NYLON LOCKNUT
10	30	1-21-015	5/16" SS HEX NUT
11	34	1-22-017	5/16" SS FLAT WASHER
12	2	1-22-018	3/8" ID X 5/8" OD RUBBER WASHER
13	2	1-22-024	3/8" SS FLAT WASHER

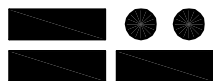

DuMor, inc.

P.O. Box 142 Mifflintown, PA 17059-0142

SCALE : NONE
 DATE DRAWN : 11/22/02
 DRAWN BY : JSB
 DATE REV. : 10/27/11
 REV. BY : RDH

TITLE : PICNIC TABLE ASSEMBLY

REV. E

DRAWING NUMBER 156 SERIES PL

SHEET 2 OF 2